



## South Section: Greenland Road to Monument

In addition to Express Lanes and wider shoulders, this section of the I-25 South Gap project will include three new wildlife crossings, reconstruction of the Greenland Road interchange and new ramps at County Line Road. Drivers can expect multiple traffic shifts and extended ramp and frontage road closures throughout the construction zone. Two lanes of traffic will remain open during daytime hours with lane closures restricted to overnight hours. Thank you for your patience.

### Traffic Impact 1: Traffic Crossover Near Greenland

Northbound I-25 traffic will crossover and travel head-to-head on southbound I-25, separated by a temporary concrete barrier near Greenland Road. All traffic will then shift onto northbound I-25 in a similar configuration. These shifts are necessary for re-construction of the Greenland Road Interchange.

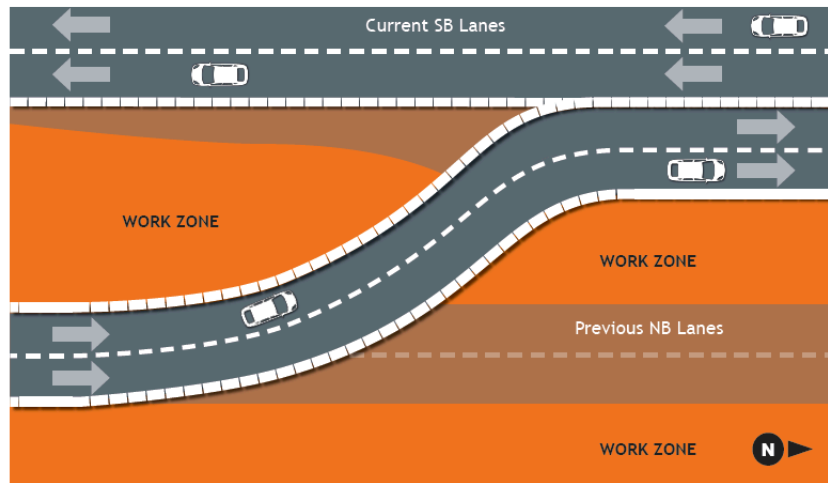

### Traffic Impact 2: Extended Ramp Closures

At Greenland Road and County Line Road, drivers can expect extended ramp closures. These closures may take place for up to a week at a time and are necessary for crews to reconstruct the on- and off-ramps at these two interchanges.

### Traffic Impact 3: Monument Hill Road Closure

To build a new wildlife crossing, Monument Hill Road at Misty Acres Boulevard will be closed for at least four months. Detours will be in place for those who travel the route. Access to Colorado Heights Camping Resort and Palmer Ridge High School will remain open.

### For Your Safety

Lanes will become narrower and speeds will be reduced in the construction zones. Please avoid distracted driving, watch your following distance and do not stop in the construction zone. A courtesy patrol will travel the south section construction zone seven days a week to help stalled vehicles.

### Contact Us!

Project Hotline: 720-745-5434  
Project Email: [i25gap@codot.us](mailto:i25gap@codot.us)

Project Website: [i25gap.codot.gov](http://i25gap.codot.gov)  
Text Alerts: Text I25GAP to 21000





# I-25 South Gap Project Monument–Castle Rock

### Future Work

By summer 2019, work will be occurring in all three sections of the I-25 South Gap project. The third section will consist of work between Greenland Road and Skyview Lane (Tomah Road). This will be the most complex part of the project and will include bridge replacements at Upper Lake Gulch Road, Spruce Mountain Road and Plum Creek. Construction of wildlife crossing will also occur in this section.

Construction is scheduled for completion in 2022.

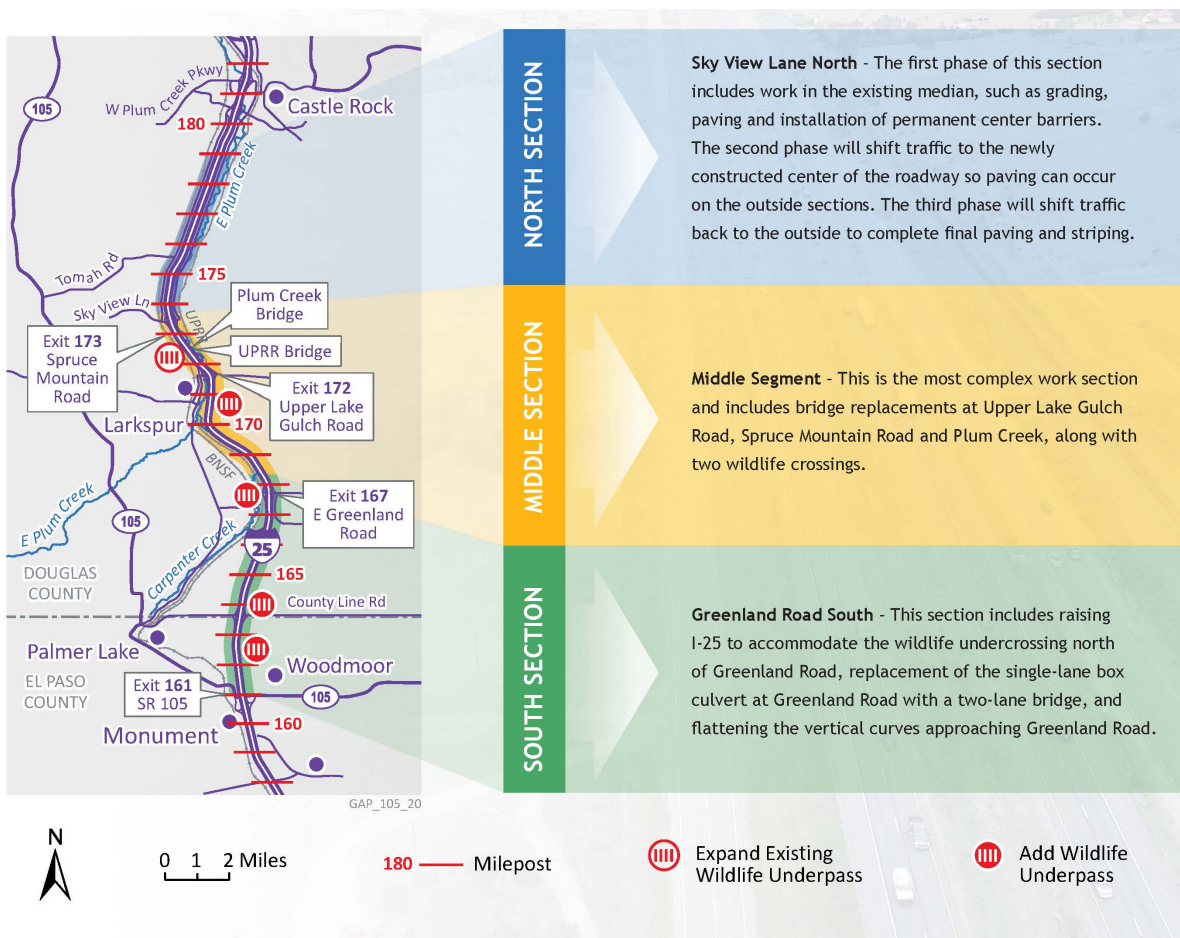

### About the I-25 South Gap Project

CDOT is improving 18 miles of I-25 from south of Castle Rock to Monument by widening the road from two to three lanes in each direction. The new lane will operate as an Express Lane, allowing motorists the choice of taking the Express Lane for a faster and more reliable travel time in exchange for a toll, or driving the general purpose lanes for free. Carpools with three or more people and motorcyclists can take the Express Lane for free.

Other improvements include widening the shoulders, rebuilding bridges, building new wildlife crossings, resurfacing the roadway with new pavement and modernizing technology. The cost of the project is \$350 million.





# I-25 South Gap Project Monument–Castle Rock

**FACT SHEET**

